

工具箱
Tool box



No.	零件编号	description	数量
No.	Part No.	Description	Qty.
1	150T-F-050301	Foot plate	1
2	150T-F-050201	Tool box	1
3	150T-F-050202	Tool box cover	1
4	150T-F-050303	filler cap	1
5	150T-F-050204	Motorcycle safety helmet pothook	1
6	150T-F-050203	Tool box rocker	2
7	150T-F-050205	number cover	1
8	150T-F-05020602	R, tool box chromium-plated part	1
9	150T-F-05020601	L, tool box chromium-plated part	1
10	150T-F-050004	R protect piece	1
11	150T-F-050003	L protect piece	1
12	150T-F-050302	oil box cover board	1

座垫总成

Seat cushion



No.	Part No.	Description	Qty.
1	150T-F-000101	Seat groupware	1
2	150T-F-000102	seat assy rocker	1
3	150T-F-050401	Sundries box	1
4	150T-F-050402	lower cap of tidy	1
5	150T-F-050500	battery box	1
6	150T-F-050403	battery cover	1
7	150T-F-050601	front cover of tidy	1
8	150T-F-05060202	chromium-plated part & front cover of tidy,R	1
9	150T-F-05060201	chromium-plated part & front cover of tidy,L	1

前大板



Front board



No.	Part No.	Description	Qty.
1	150T-F-050100	Fr board	1
2	150T-F-050101	L/Fr turinglight	1
3	150T-F-050102	R/Fr turinglight	1
4	150T-F-050103	big board decorate board	1
5	150T-F-050104	big board chromium-plated part	1
6	150T-F-05010101	L/Fr turinglight chimney	1
7	150T-F-05010102	L/Fr turinglight RR chimney	1
8	150T-F-05010103	Fr turing light bulb 12V 10W	1
9	150T-F-05010104	L/Fr turinglight Holder	1

燃油箱总成

Fuel tank

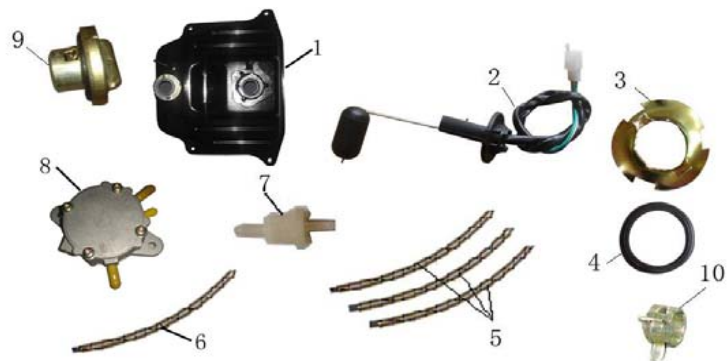

No.	Part No.	Description	Qty.
1	150T-F-060100	Fuel tank	1
2	150T-F-060101	Oil digit sensor	1
3	150T-F-060102	Sensor press board	1
4	150T-F-060103	Sensor airproof circle	1
5	150T-F-060001	Gasoline pipe	3
6	150T-F-060003	Vacuum tube	1
7	150T-F-060106	filter	1
8	150T-F-060104	self-priming switch	1
9	150T-F-060105	Cover, gasoline tank	1
10	150T-F-060002	Circlip	1

装饰板&尾灯
Plate comp plastec&tailligt



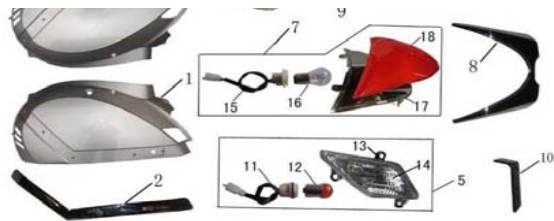

No.	Part No.	Description	Qty.
1	150T-F-050801	left decorate board	1
2	150T-F-050802	left decorate piece	1
3	150T-F-050803	right decorate board	1
4	150T-F-050804	right decorate piece	1
5	150T-F-050805	l/rr turinging light	1
6	150T-F-050806	r/rr turinging light	1
7	150T-F-050701	Rr taillight	1
8	150T-F-050702	taillight chromium-plated part	1
9	150T-F-030001	Key Set Comp.	1
10	150T-F-050807	decorate board stand	1
11	150T-F-05080501	l/rr turinging light Holder	1
12	150T-F-05080502	Bulb winker 12V 10W	1
13	150T-F-05080503	Body comp.l/rr turinging light	1
14	150T-F-05080504	Lens L.RR.winker	1
15	150T-F-05070101	tail light Holder	1
16	150T-F-05070102	Bulb tail light 12V 21W/5W	1
17	150T-F-05070103	Body comp.tail light	1
18	150T-F-05070104	Lens taillight	1

后尾板&车架挡泥板

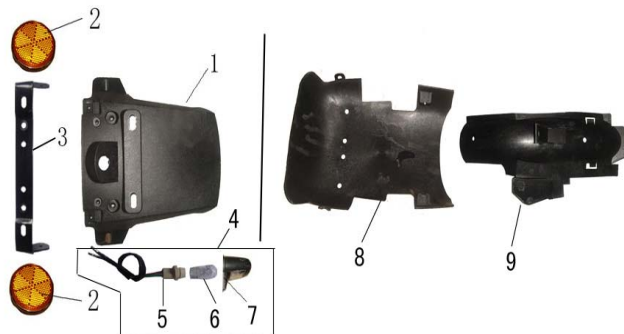

No.	Part No.	Description	Qty.
1	150T-F-050900	Rr trail board	1
2	150T-F-050902	Side reflector	2
3	150T-F-050901	Rr licence plate bracket	1
4	150T-F-050903	Rr licence light	1
5	150T-F-05090301	Rr licence light lamp holder	1
6	150T-F-05090302	Rr licence light bulb 12V 5W	1
7	150T-F-05090303	Rr licence light chimney	1
8	150T-F-050001	Fr frame fender	1
9	150T-F-050002	Rr frame fender	1

載物架
Luggage carrier





No.	Part No.	Description	数量 Qty.
1	150T-F-000200	Luggage carrier	1
2	150T-F-000201	Rr refelctor	1

蓄电池
Battery

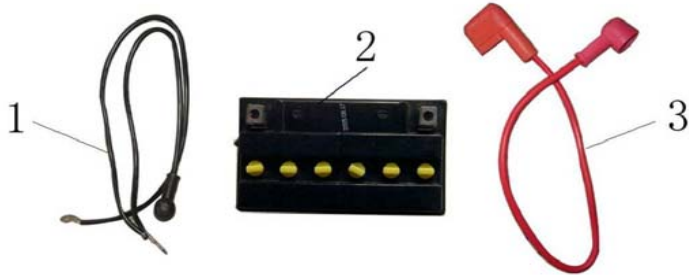

No.	Part No.	Description	Qty.
1	150T-F-070005	Cathode line	1
2	150T-F-070400	Battery assy 12V 7Ah	1
3	150T-F-070006	Anode line	1

主电缆
Wire harness

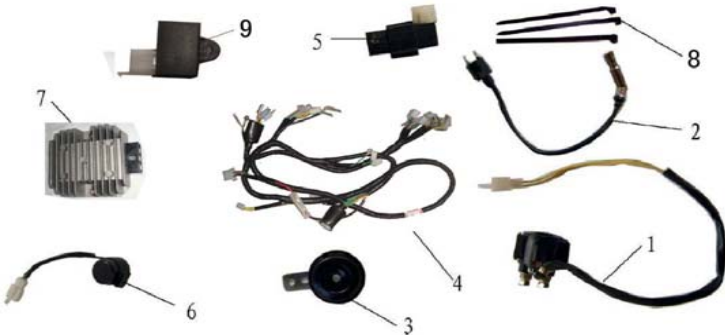

No.	Part No.	Description	数量 Qty.
1	150T-F-070100	Start-up relay	1
2	150T-F-070200	Ignition loop	1
3	150T-F-070300	horn	1
4	150T-F-070001	cable	1
5	150T-F-070002	ignition	1
6	150T-F-070003	flasher	1
7	150T-F-070004	manostat	1
8	150T-F-090010	wrap	1set
9	150T-F-070007	controller	1

前轮

Front wheel



No.	Part No.	Description	Qty.
1	150T-F-010201	Fr al wheel (2.50*12)	1
2	150T-F-010202	Vacual tire (120/70-12)	1
3	150T-F-010203	Value mouth	1
4	150T-F-010204	disc brake plate (Φ190mm)	1
5	150T-F-010205	disc brake plate bolt M8*25	3
6	150T-F-010008	Front-wheel drive axle 12*20*44	1
7	GB617708601	M12X1.25 locknut	1
8	150T-F-010300	driver	1
9	150T-F-020204	odometer soft axes	1
10	150T-F-010007	Front axle M12*250	1
11	150T-F-01020101	Dust seal	1
12	GB27606401	Bearing 6201-2RS	2
13	150T-F-01020102	Fr wheel axle, collar φ12*44	1
14	150T-F-01020103	front-wheel hub	1

后轮

Rear wheel

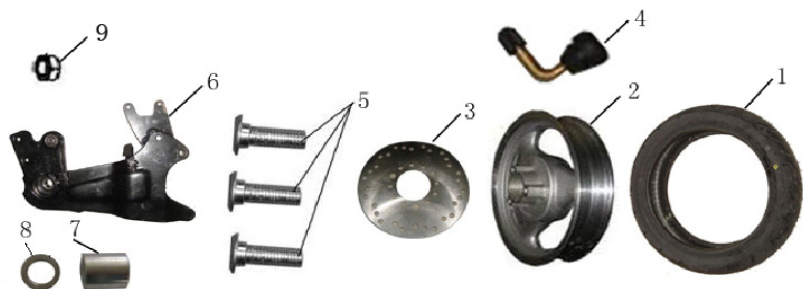

No.	Part No.	Description	Qty.
1	150T-F-010202	Vacunm tire (120/70-12)	1
2	150T-F-040500	Rr al wheel (2.50*12)	1
3	150T-F-010204	disc brake palte (Φ190mm)	1
4	150T-F-010203	Vavle mouth	1
5	150T-F-010205	disc brake plate bolt M8*25	3
6	150T-F-040700	Three corner connection board	1
7	150T-F-04000701	Rr wheel bush (17*25*24)	1
8	150T-F-04000702	Rr wheel bush (17*25*10)	1
9	GB578708601	Six corner nut M16X1.5	1

后碟刹总成

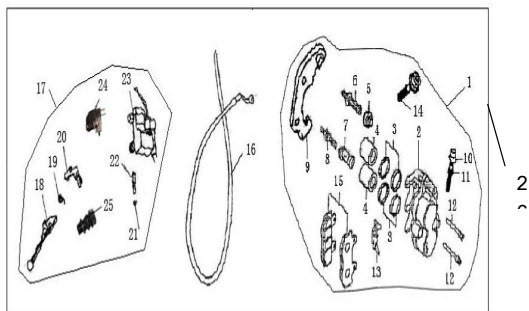

No.	Part No.	Description	Qty.
1	150T-F-040902	Rr disc brake down pump	1
2	150T-F-04090201	Oil cylinder	1
3	150T-F-04090202	dustproof set piece	2
4	150T-F-04090203	oil crock pin	2
5	150T-F-04090204	bolt pin glue circle	1
6	150T-F-04090205	bolt pin A	1
7	150T-F-04090206	bolt pin bush	1
8	150T-F-04090207	bolt pin	1
9	150T-F-04090208	disc brake pump decorate board	1
10	150T-F-04090209	Cover	1
11	150T-F-04090210	Bolt of exhaust	1
12	150T-F-04090211	orientation bolt pin	2
13	150T-F-04090212	diaplasis spring	1
14	150T-F-04090213	bolt,oil inlet	1
15	150T-F-04090214	Rear trig disc brake piece	1set
16	150T-F-040903	oil pipe	1
17	150T-F-040901	Rr disc brake pump	1
18	150T-F-04090101	Grip comp handle L	1
19	150T-F-04090102	Retuming spring	1
20	150T-F-04090103	Connecting socket	1
21	150T-F-04090104	Nut M5	1
22	150T-F-04090105	Bolt comp handle L	1
23	150T-F-04090106	Oil cylinder ,Rr brake comp	1
24	150T-F-04090107	Switch, rear stop	1
25	150T-F-04090108	bolt,oil inlet	2
26	150T-F-040900	rr disc brake pump	1

仪表组件



No.	Part No.	Description	数量
1	150T-F-020203	speedometer groupware	1

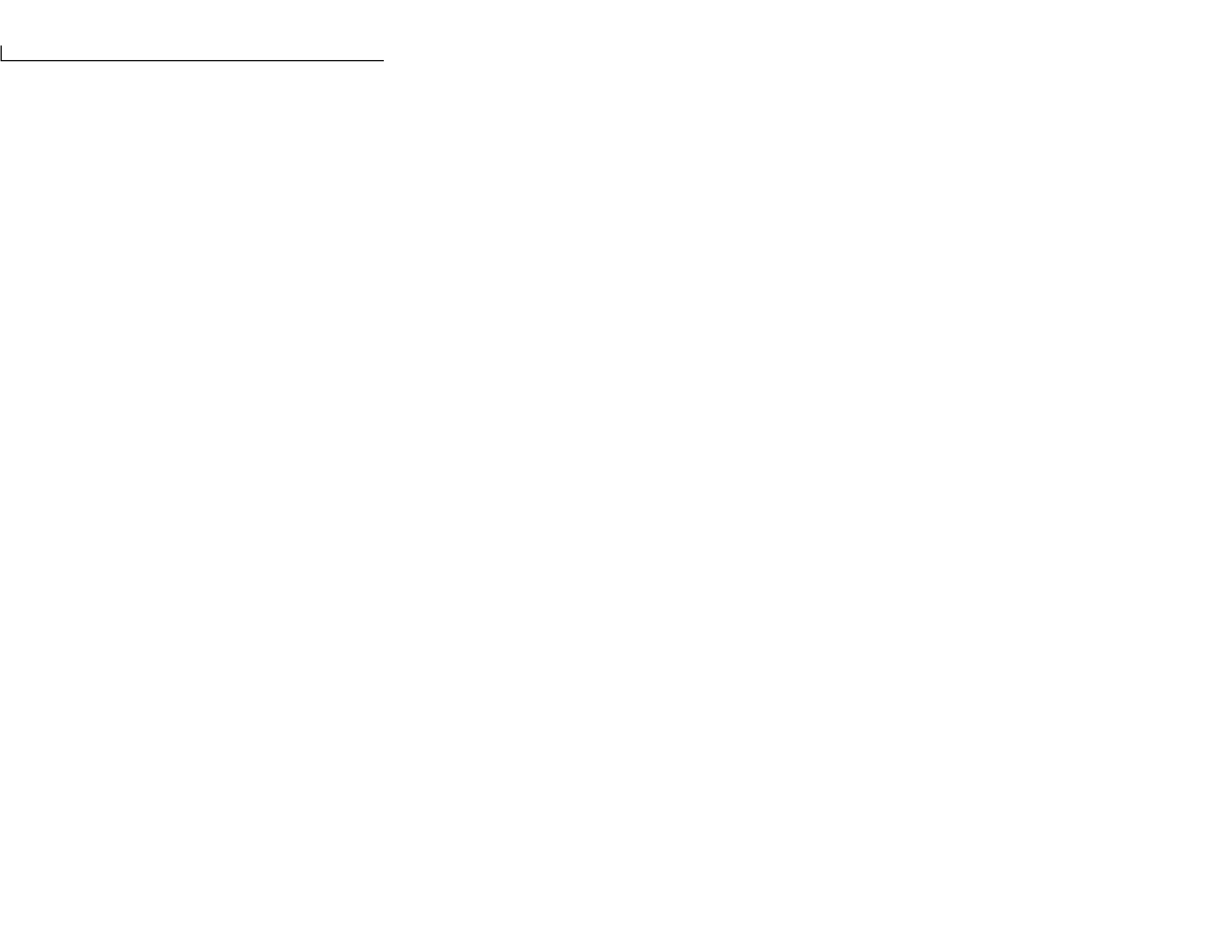

大灯

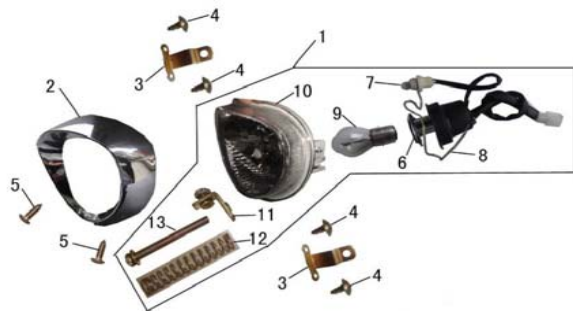

No.	Part No.	Description	Qty.
1	150T-F-020102	headlight gropware	1
2	150T-F-020101	headlight cover	1
3	150T-F-020103	headlight stand	2
4	GBT84508501	tapping screw 4.2×8	4
5	GBT84508502	tapping screw 4.2×16	2
6	150T-F-02010201	headlight lamp holder	1
7	150T-F-02010202	sidelights bulb 12V 5W	1
8	150T-F-02010203	lathe dog	1
9	150T-F-02010204	headlight bulb 12V 35W/35W	1
10	150T-F-02010205	headlight chimney	1
11	150T-F-02010206	headlight regulating stand	1
12	150T-F-02010207	regulating spring	1
13	150T-F-02010208	cap bolt	1

方向把

Headlight



No.	Part No.	Description	Qty.
1	150T-F-020500	direction hand	1
2	150T-F-020201	up cover of direction hand	1
3	150T-F-020205	down cover of direction hand	1
4	150T-F-020202	speedometer cover	1
5	150T-F-020400	L combination switch	1
6	150T-F-020300	left hand glove	1
7	150T-F-020800	handle back balance	1
8	150T-F-000301	left rearview mirror	1
9	150T-F-020700	R combination switch	1
10	150T-F-020600	accelerograph turing hand	1

11	150T-F-000302	right rearview mirror	1
12	150T-F-000004	lock tighten set	1
13	150T-F-020900	accelerograph cable	1

前碟刹总成

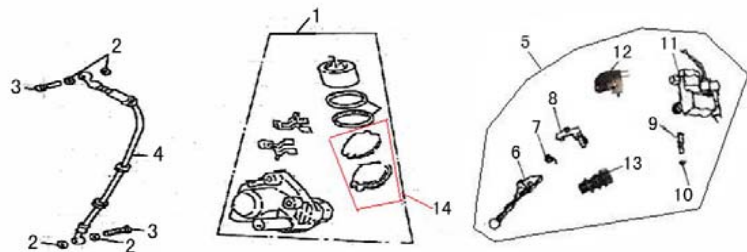

No.	Part No.	Description	数量 Qty.
1	150T-F-010401	Grip assy.brake Rr.	1
2	150T-F-01040301	Washer	4
3	150T-F-01040302	Bolt	2
4	150T-F-010403	Tube brake Fr.	1
5	150T-F-010402	Fr disc brake pump	1
6	150T-F-01040201	Grip comp handle R	1
7	150T-F-01040202	Returning spring	1
8	150T-F-01040203	Connecting socket	1
9	150T-F-01040204	Nut M5	1
10	150T-F-01040205	Bolt comp handle R	1
11	150T-F-01040206	Oil cylinder ,Fr brake comp	1
12	150T-F-01040207	Switch, front stop	1
13	150T-F-01040208	bolt,oil inlet	2
14	150T-F-01040101	Disc brake piece	2

发动机总成
Engine Assy

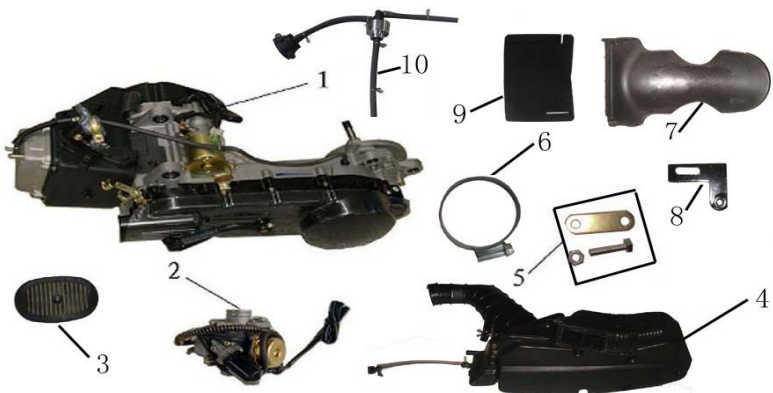

No.	Part No.	Description	Qty.
1	150TF8040100	engine	1
2	150TF8040200	carburetor	1
3	150T-F-040002	ventilate pipe groupware	1
4	150T-F-040300	Air filter groupware	1
5	150T-F-040302	air filter frame	1
6	150T-F-040301	Air cleaner holder, air pipe	1
7	150T-F-040004	Rr wheel fender	1

8	150T-F-040005	Rr wheel fender stand	1
9	150T-F-040006	breakwater	1
10	150T-F-040001	air colander enterwindpipe	1

后减震器

Fear cushion



No.	Part No.	Description	数量
1	150T-F-040401	L rear absorber	1
2	150T-F-04040101	absorber cushion gasket	2
3	150T-F-04040102	absorber bush	2
4	GB578708602	Bolt flange M10X40	2
5	GB578708603	Bolt flange M8X30	2
6	150T-F-040402	R rear absorber	1

前叉
Front fork



No.	Part No.	Description	Qty.
1	150T-F-010101	Down connection groupware	1
2	150T-F-010003	L rocker protected cover	1
3	150T-F-010004	R rocker protected cover	1
4	GB578708604	Bolt FLANGE M6X20	2
5	150T-F-01010402	Dust seal	4
6	150T-F-01010201	Fr.cushion under collar	2
7	GB617708602	Nut M8	2
8	150T-F-01010501	R rocker	1
9	150T-F-01010202	Fr.cushion under collar	2

10	150T-F-01010403	Rocker collar	2
11	150T-F-01010203	Fr.cushion under dust seal	4
12	150T-F-01010204	Cover Fr.ccushon under dust seal	4
13	150T-F-01010401	R rocker	1
14	150T-F-010001	L absorber protected cover	1
15	150T-F-010002	R absorber protected cover	1
16	GBT818020000	M6X16	4
17	150T-F-01010601	Disc brake rocker	1
18	150T-F-01010602	But disc brake rocker	1
19	GB578008601	Bolt M8X30	1
20	150T-F-010102	L/R front shock absorber	1set
21	GB578708605	Bolt FLANGE M8X40	2
22	GB618708601	Bolt flange M8	2
23	150T-F-000003	compaction nut	1
24	150T-F-00000101	Steering top cone race	1
25	150T-F-00000102	Steel ball top	1
26	150T-F-00000103	Steering upper ball race	1
27	150T-F-00000201	Steering bottom ball race	1
28	150T-F-00000202	Steel ball bottom	1
29	150T-F-00000203	Steering bottom cone race	1
30	GB618708602	Bolt flange M10X1.25	2
31	GB578708606	Bolt flange M8X37	2
32	150T-F-010104	L rocker assy	1
33	150T-F-010105	R rocker assy	1
34	150T-F-010005	the front of the Fr wheel fender	1
35	150T-F-010006	the front of the Rr wheel fender	1